

ON LEFT LANE

**Only vehicle/s
Posted speed 50km/h or less**

140

Notes:

1. Work at low volume time wherever possible
2. All vehicles must display amber flashing beacon/s clearly visible to traffic in both directions
3. Tail pilot vehicle needed where the operation stops and rear visibility is less than 50m on 50km/h road
4. Approval from TMC is required where posted speed limit exceeds 50km/h
5. Where the situation is constantly changing and it is impractical to change the RG17/34 frequently, this component may be omitted from the **work vehicle**

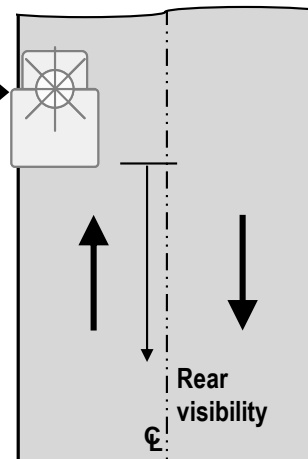
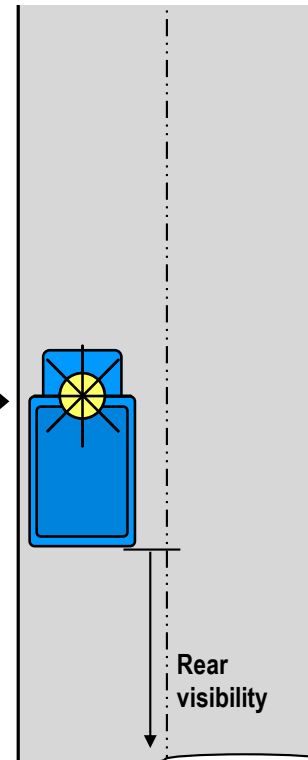
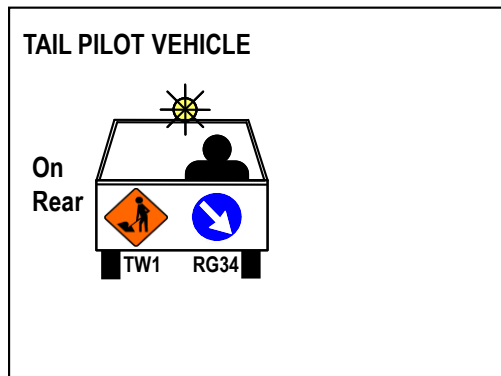
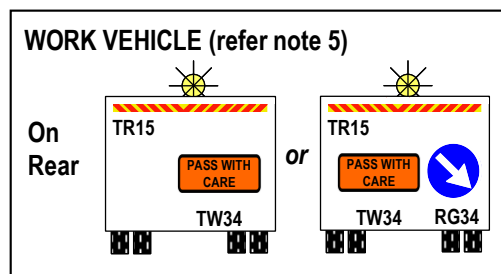

VEHICLE
PROTECTED
MOBILE

NOT TO SCALE

ON LEFT LANE

With foot-workers

Posted speed 50km/h or less

Notes:

1. Work at low volume time wherever possible
2. All vehicles must display amber flashing beacon/s clearly visible to traffic in both directions
3. Tail pilot vehicle needed where the operation stops and rear visibility is less than 50m on 50km/h road
4. A shadow vehicle is required for protection of foot-workers where they are in a Live Lane behind the work vehicle, unless their work is carried out safely in a manner consistent with Inspection Activities
5. Approval from TMC is required where posted speed limit exceeds 50km/h
6. Where the situation is constantly changing and it is impractical to change the RG17/34 frequently, this component may be omitted from the **work and shadow vehicle**

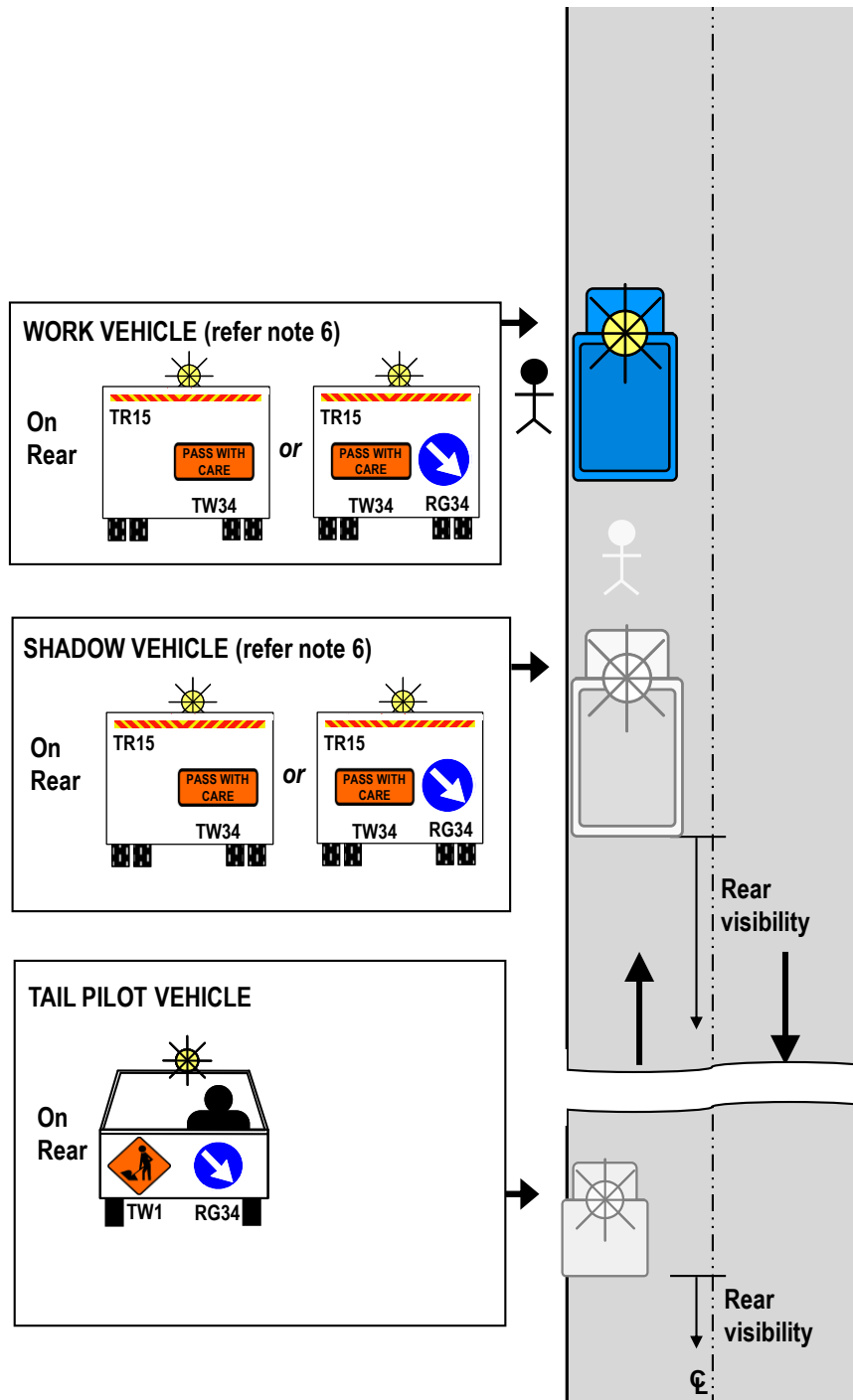

NOT TO SCALE

ON RIGHT LANE

Only vehicle/s

Posted speed 50km/h or less

Notes:

1. Work at low volume time wherever possible
2. All vehicles must display amber flashing beacon/s clearly visible to traffic in both directions
3. Tail pilot vehicle needed where the operation stops and rear visibility is less than 50m on 50km/h road
4. Approval from TMC is required where posted speed limit exceeds 50km/h

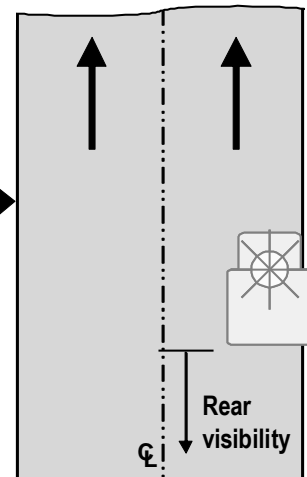
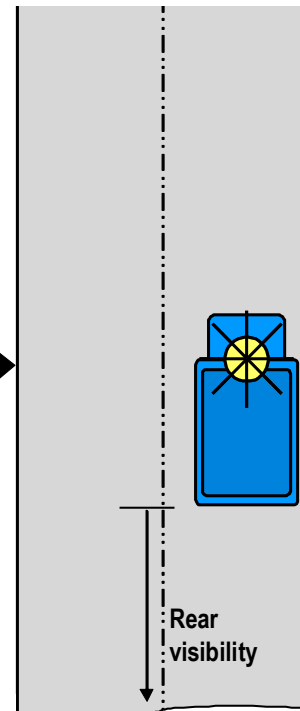
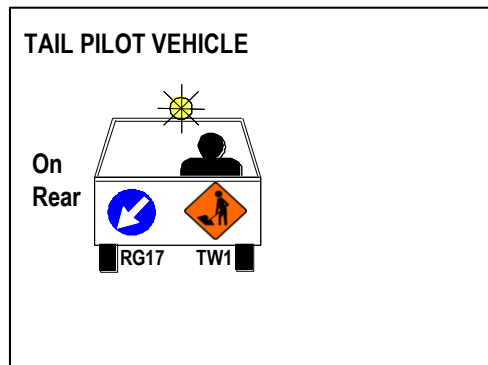
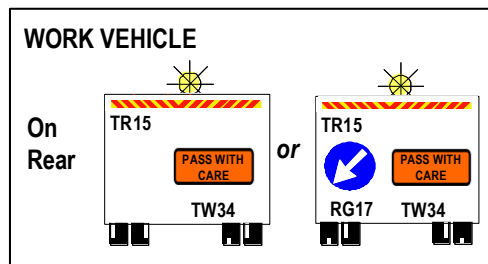

VEHICLE PROTECTED MOBILE

NOT TO SCALE

ON RIGHT LANE

With foot-workers

Posted speed 50km/h or less

Notes:

1. Work at low volume time wherever possible
2. All vehicles must display amber flashing beacon/s clearly visible to traffic in both directions
3. Tail pilot vehicle needed where the operation stops and rear visibility is less than 50m on 50km/h road
4. A shadow vehicle is required for protection of foot-workers where they are in a Live Lane behind the work vehicle, unless their work is carried out safely in a manner consistent with Inspection Activities
5. Approval from TMC is required where posted speed limit exceeds 50km/h

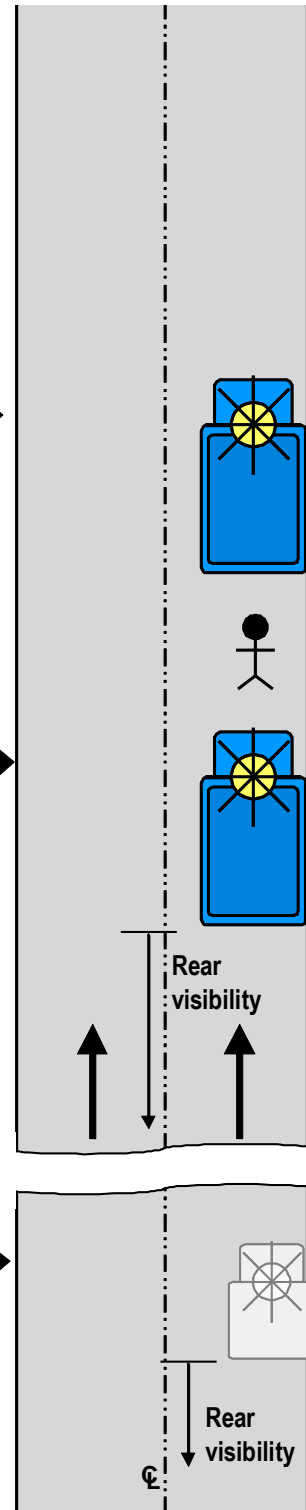
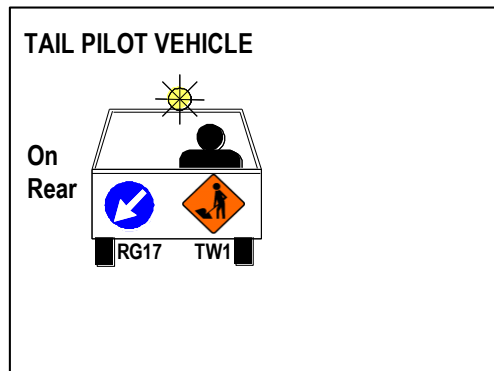
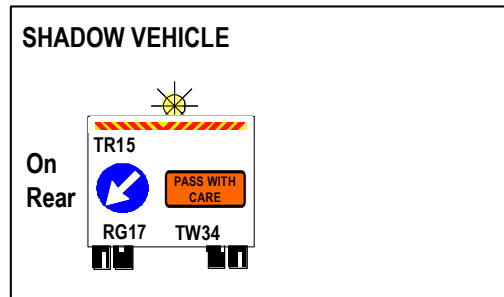
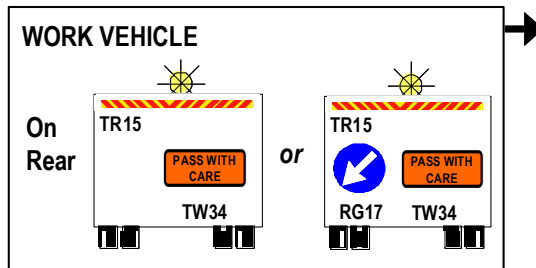

NOT TO SCALE